



Spett.le Ditta:

HELMUT STAUDE GmbH & Co KG  
MEELBAUMSTRASSE 5  
30165 HANNOVER

Ordine:

Data:

Riferimento:

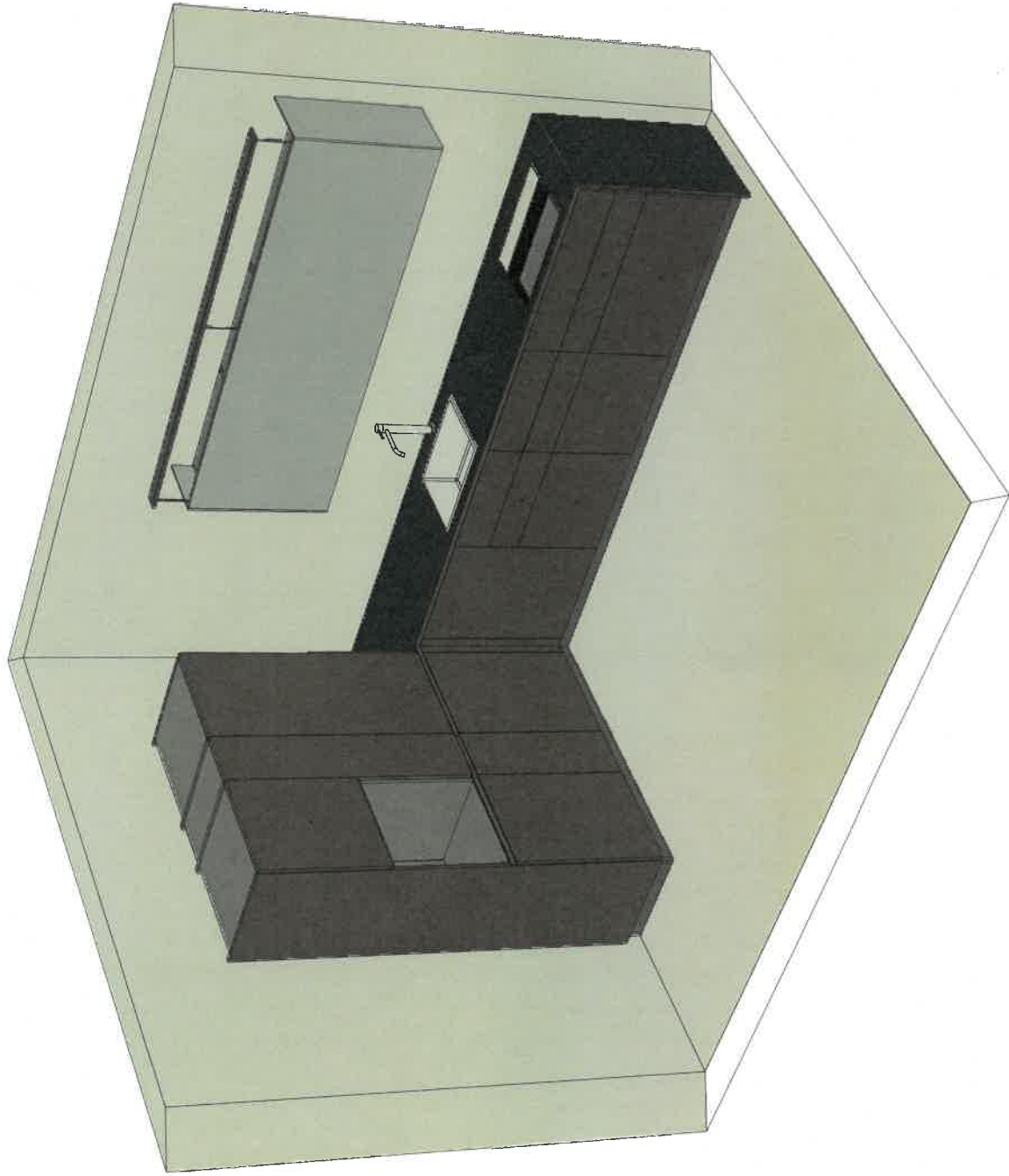

Cliente - Customer:  
Punto vendita - Point of

K01 FM  
Reference:

Prov.: HANNOVER  
Place: **PORDENONE**

Model/Version:

Worktop:

Handle Version:

Plinth:

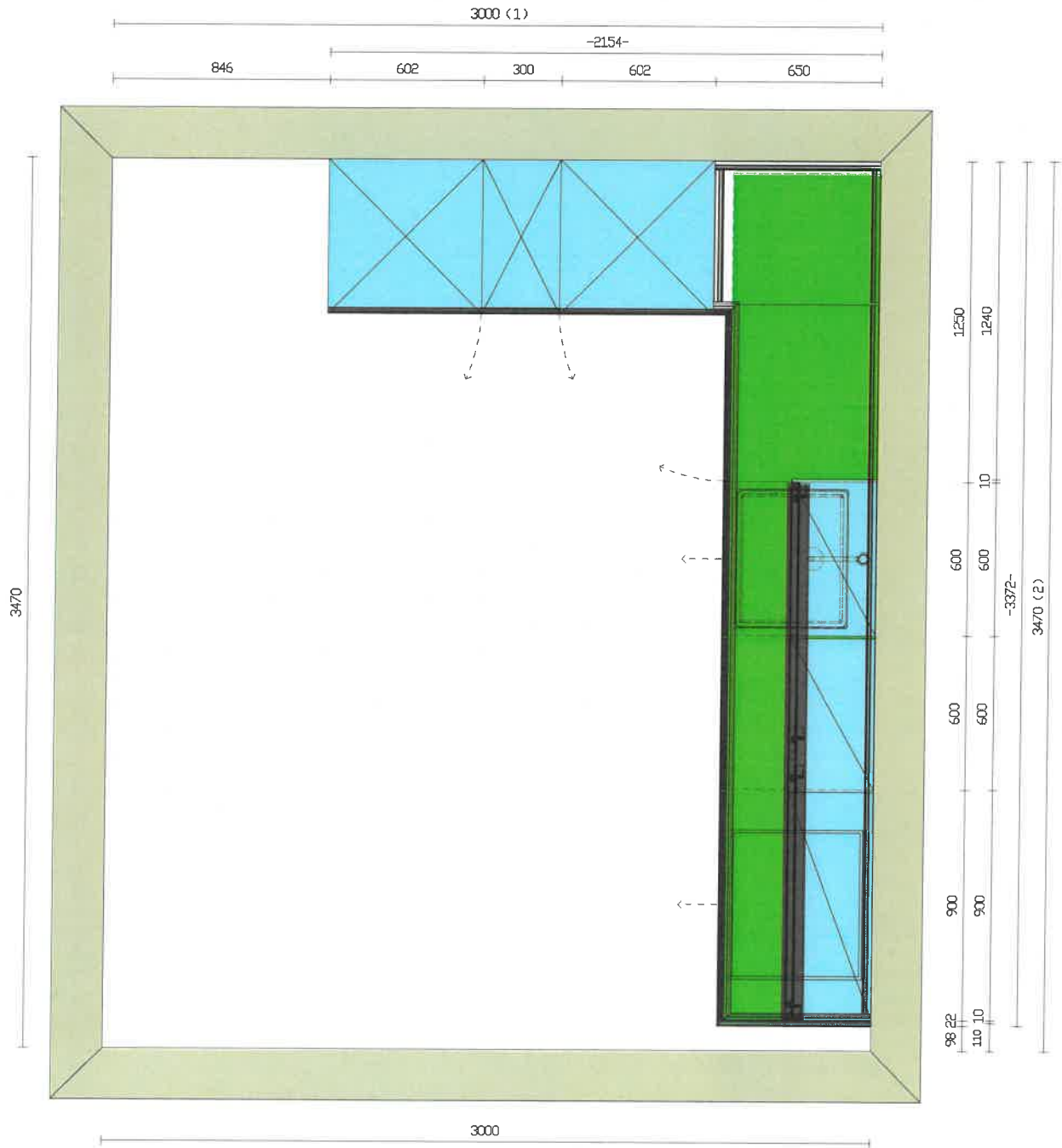

presa acqua e scarico  
Water and drain connection

attacco gas  
Gas connection

camino per cappa  
Hood chimney fitting

Presa Elettrica  
Power Point

Data Creazione Disegno:  
Drawing Creation Date:

**09/02/2022**

Ora Creazione Disegno:  
Drawing Creation Time:

**16:30**

Scala:  
Scale:

**1/24**

Misure in:  
Measurements in

**mm**

Cliente - Customer:

Punto Vendita - Point of sale:

Model/Version:

Handle/Version:

Finish:

Prov.:  
HANNOVER  
Place:

**PORDENONE**

Worktop:

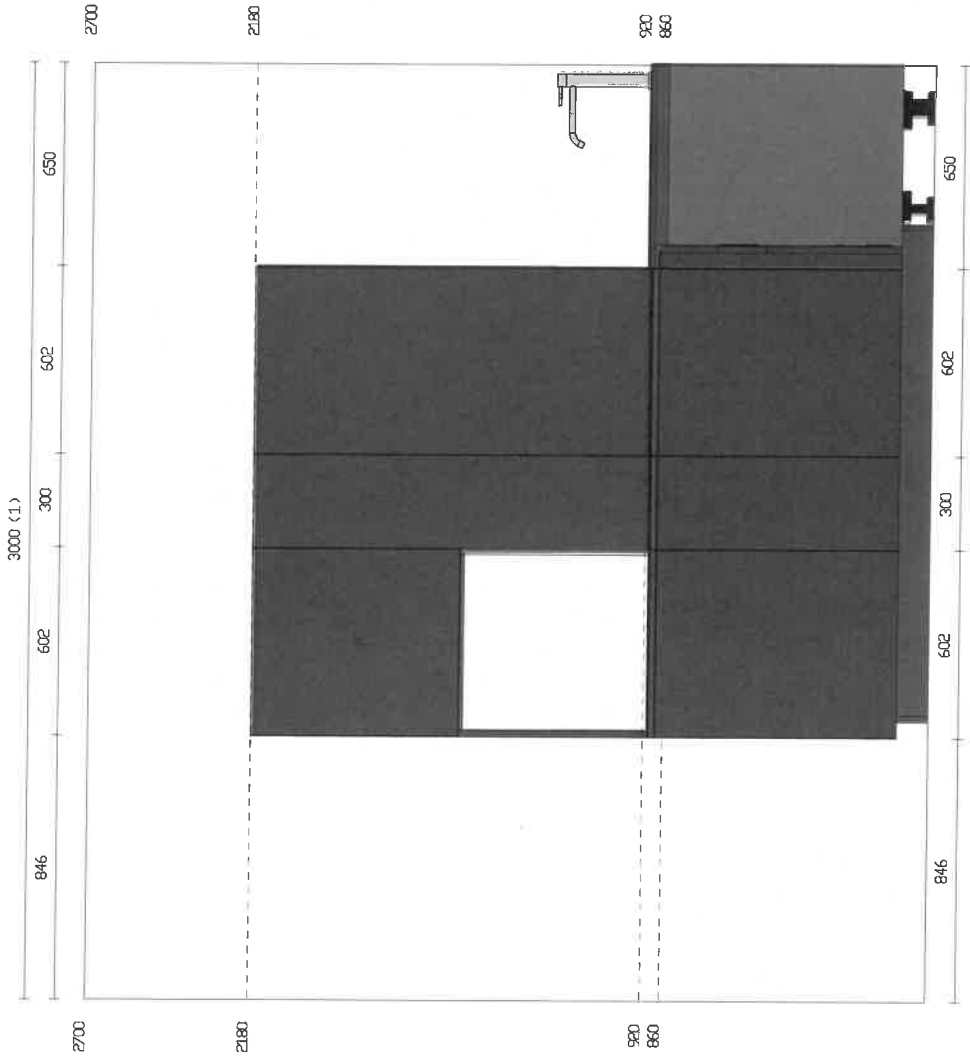

Client: - Customer:

Punto Vendita - Point of sale:

Model/Version:

Handle/Version:

Finish:

Prov.:

HANNOVER  
Piazza:  
**PORDENONE**

Worktop:

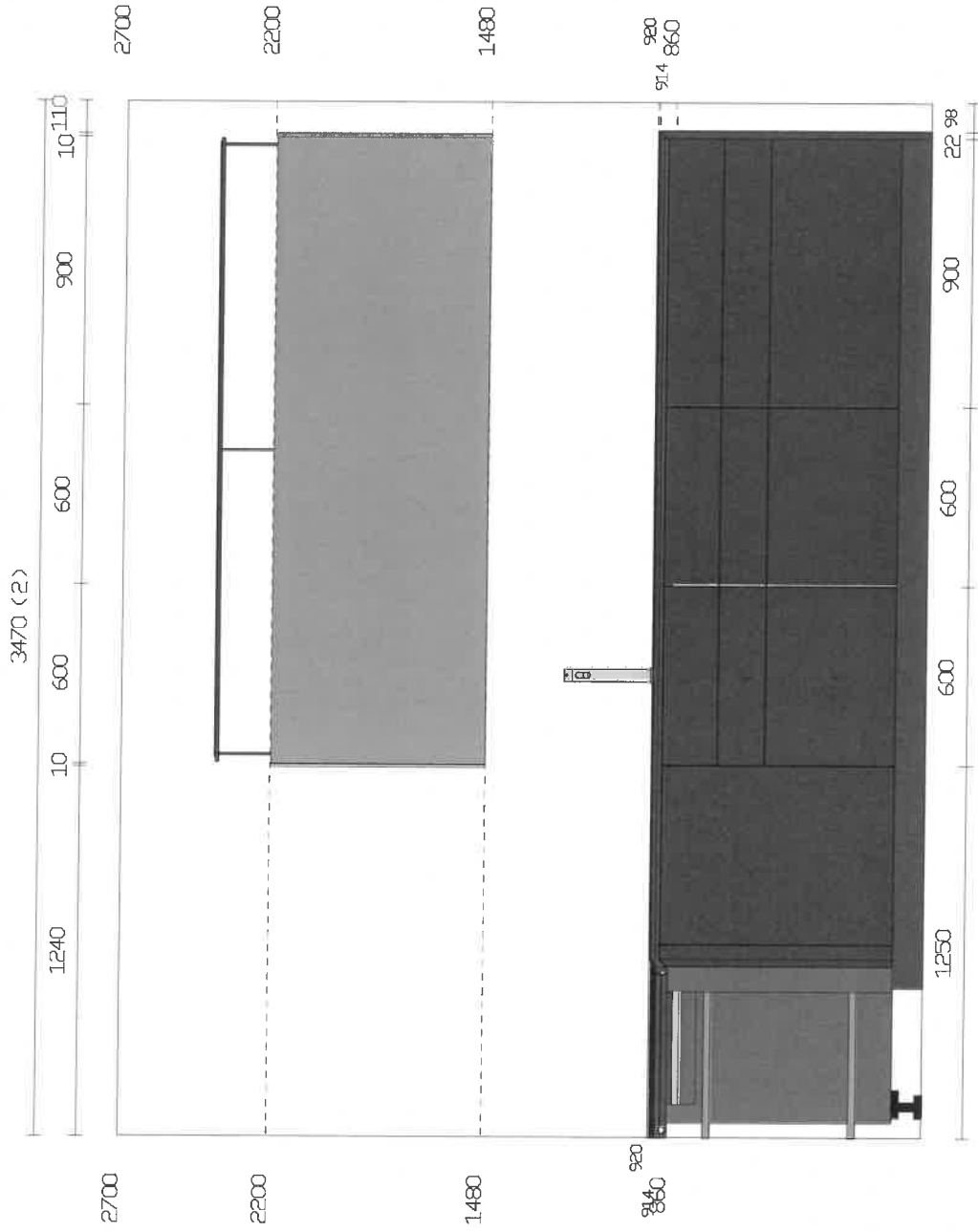

Finitura BORDI: \* > Bordo a VISTA  
 \* > Bordo NON a VISTA

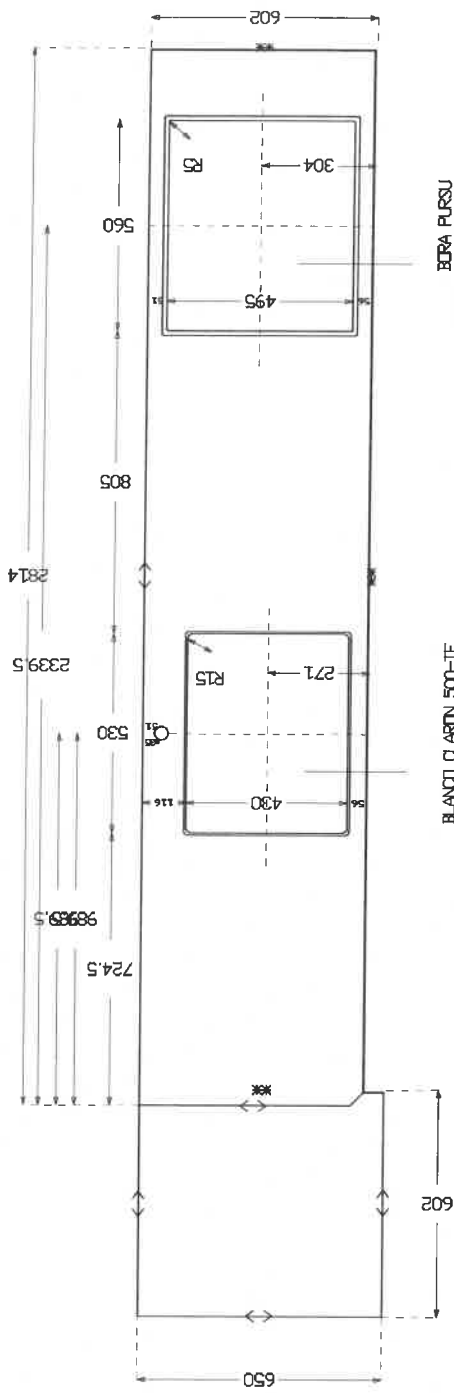

ETRA PURSU  
 RIBASSO X=12 X1=12 SP=7 R=5  
 FURTO PIANO COTTURA (CLIENTE)

BLANCO CLARON 500-IF  
 RIBASSO X=5.5 X1=5.5 SP=1.5 R=10.5  
 FURTO LAVELLO - INCASSO A FILLO

H6 INCLINATO

Codice: \_\_\_\_\_  
 Descrizione: (1) [15-0] ZP170210 - TOP H6 INCLINATO PROF.60,2 AL ML LAMINATO ARDESIA FINITURA MATRIZONA VISTA  
 (2) [16-0] ZP170210 - TOP H6 INCLINATO PROF.60,2 AL ML LAMINATO ARDESIA FINITURA MATRIZONA VISTA  
 Bordo SX  
 Bordo DX  
 NON A VISTA  
 INCLINATA

Spett.le Ditta: HELMUT STAUDE GmbH & Co KG  
 MELBAUMSTRASSE 5  
 30165 HANNOVER

Ordine: \_\_\_\_\_  
 Riferimento: \_\_\_\_\_





Spett.le Ditta: **HELMUT STAUDE GmbH & Co KG**  
MEELBAUMSTRASSE 5  
30165 HANNOVER

Ordine:  
Riferimento:

Data:

Dimensioni:

Lunghezza = 2814 Profondità = 602

Finitura BORDI: \*\*  
<> Bordo a VISTA  
<> Bordo NON a VISTA

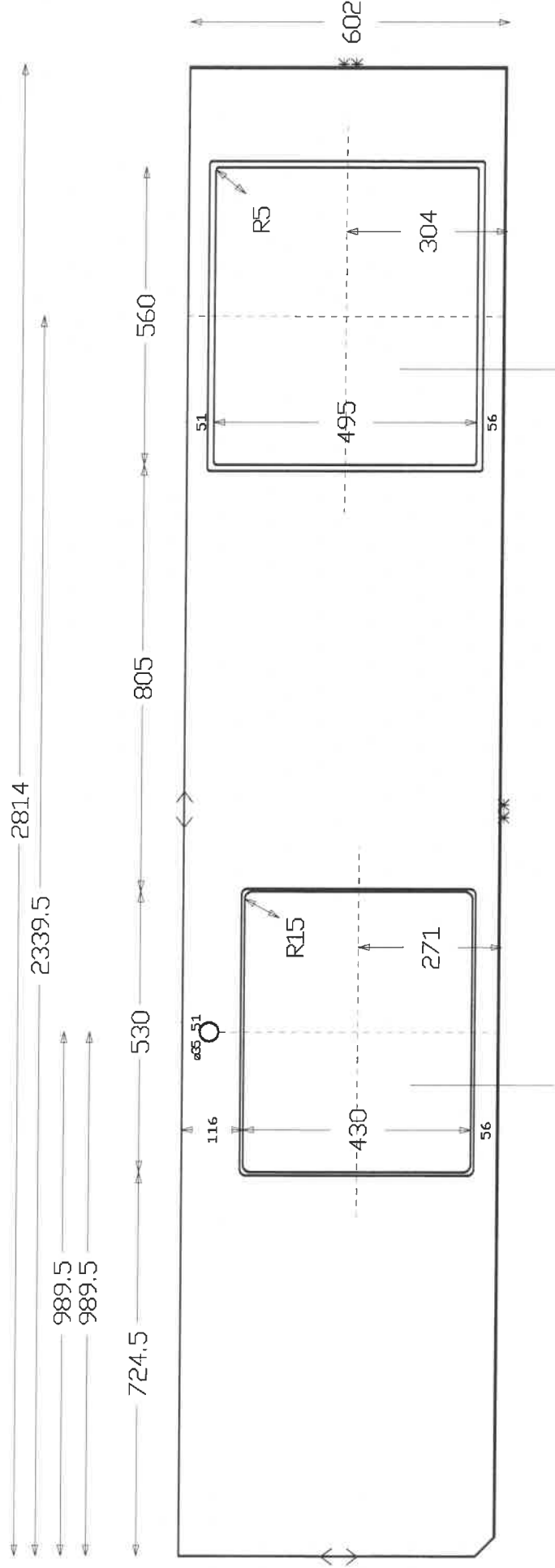

BLANCO CLARIN 500-IF  
RIBASSO X=5.5 Xt=5.5 SP=1.5 R=10.5  
FORO LAVELLO - INCASSO A FILO

BORA PURSU  
RIBASSO X=12 Xt=12 SP=7 R=5  
FORO PIANO COTTURA <CLIENTE>

Articolo

Finitura

**LAMINATO ARDESIA FINITURA MATERICA**

Finitura Struttura

**NERO**

Note di Produzione

Note Fuori Misura

Bordo Posteriore

**NON A VISTA**

Bordo Destro

**INCLINATA**

Bordo Sinistro

**NON A VISTA**

Ribassamento

X / Xt

[SP



**Prospetto della Composizione**  
**Perspective view of composition**

Prov.: **HANNOVER**  
Place:

**PORDENONE**

Worktop:

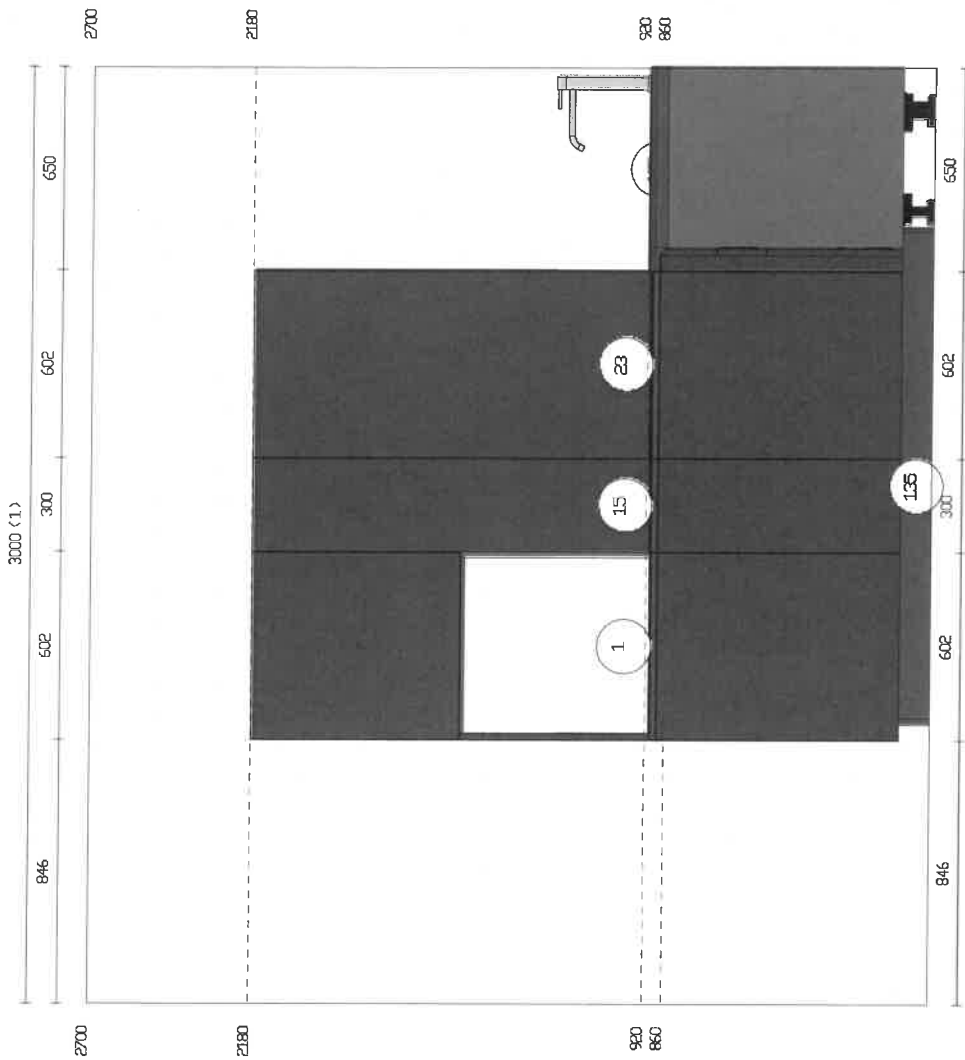

Cliente - Customer:

Punto Vendita - Point of sale:

Model/Version:

Handle Version:

Finish:

HANNOVEK  
Place:

**PORDENONE**

Worktop:

Prov.:

